

7. Network Function

7.1 Equipment installation

Connect HD video camera to your internet or your PC via network cable, or connect by Switch/Router.

You can log into the camera's web interface with the default or modified IP. (Different models have different IP, please check the default IP at the bottom of the camera.)

7.1.1 How to query the IP address of your PC (Note the text in the box)

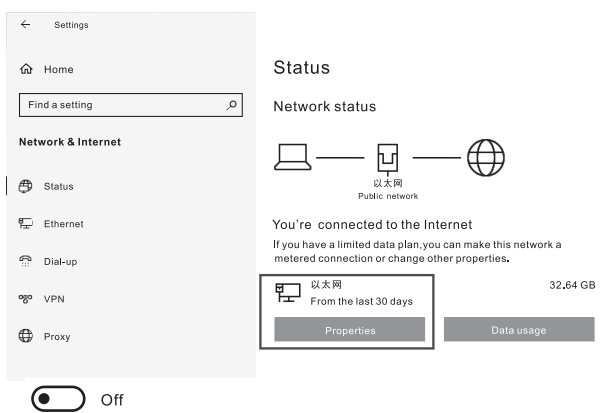
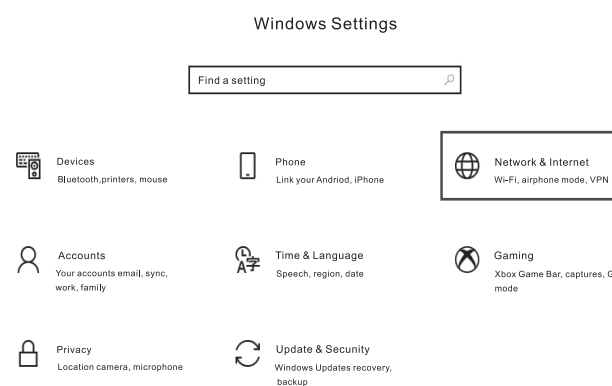

If you set a data limit, Windows will set the metered connection setting for you to help you stay under your limit.

Set a data limit to help control data usage on this network

IP settings

IP assignment: Automatic (DHCP)

Edit

Properties

Link speed (Receive/Transmit): 1000/1000 (Mbps)
Link-local IPv6 address: fe80::b1b8:1f9a:3e4d:4899%3
IPv4 address: 192.168.110.73
IPv4 DNS servers: 192.168.110.1
Primary DNS suffix: lan
Manufacturer: Realtek

7.2 How to add networking:

7.2.1 Open the computer network local connection attribute window

select "Internet Protocol Version 4 (TCP/IPv4)";

7.2.2 Double-or-right-click "Internet Protocol Version 4 (TCP/IPv4)";

7.2.3 Enter the "Internet Protocol Version 4 (TCP/IPv4) "window.

7.2.4 Change the computer's IP to 192.168.1.73 so that the computer IP and camera IP are on the same network segment.

P.S. Failure to add the correct network segment may result in login failure. The default IP address of the camera is 192.168.1.205. It's necessary to add the "1" network segment to the computer. Ensure the assigned IP address does not conflict with other devices on the network. Verify the IP address's availability before assigning it.

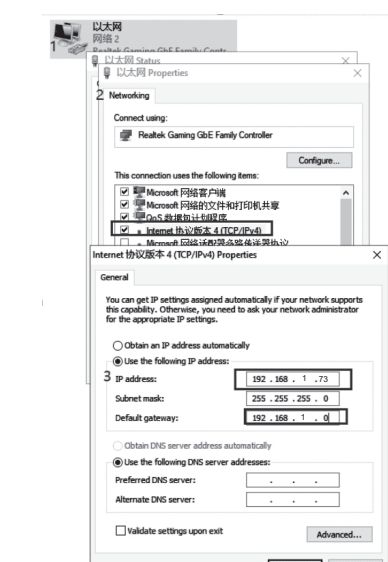

7.3 Input http:// 192.168.1.205 to IE (better with IE or Google web browser), then a login window will pop up; Input user name: admin, password: admin; and choose language: English, shown as below, whether the IP already exists.

7.3.1 When logging in for the first time, will be prompted to change your password. Users can change the passwords and save it.

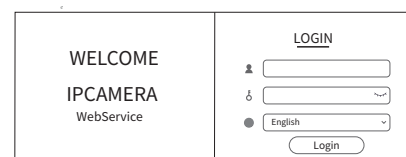

7.3.2 After successfully login, you will enter the Video viewing interface.

In the setting interface, you can set Pan and tilt control, Zoom, Focus, and set, call, clear of preset positions, etc.

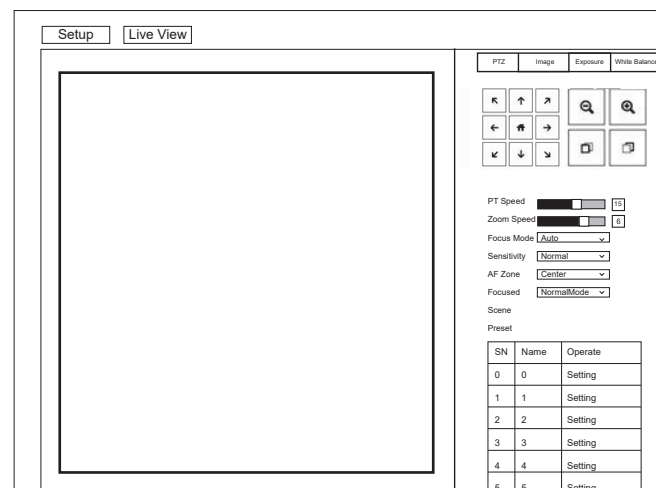

7.4 Modify the camera IP and computer IP on to the same network segment, so that the computer network is not affected.

7.4.1 Select "Setup"- "Network Settings"- "Local Network" to enter the following interface:

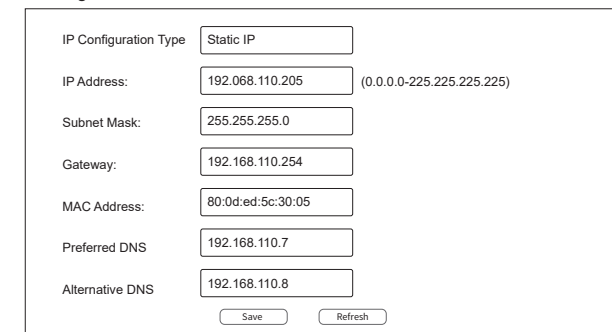

7.4.1.1 Change the camera IP address to: 192.168.110.205

7.4.1.2 Default Gateway: 192.168.110.254

7.4.1.3 Alternate DNS: 192.168.110.7

7.4.1.4 Preferred DNS: 192.168.110.8

7.4.2 Return PC's IP to the original IP address, and select Obtain an IP address automatically

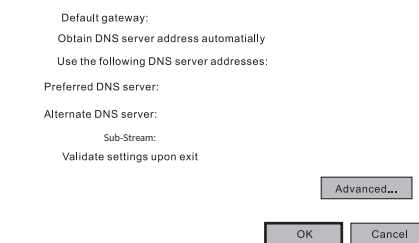
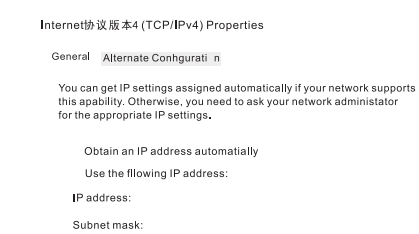

7.5 Video streaming

7.5.1 Select "Setup"- "Video Settings"- "System Settings" to enter the following interface:

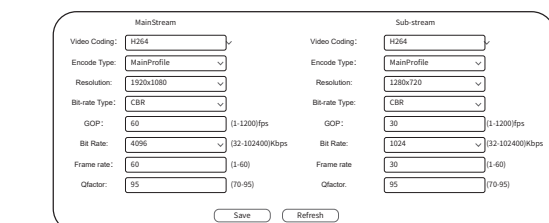

7.5.2 RTSP video streaming

Select "Setup"- "Network Settings"- "RTSP" to enter following interface:

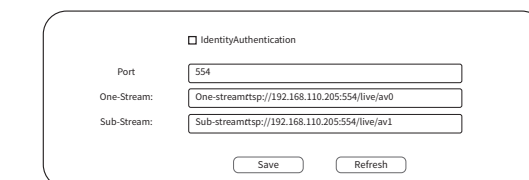

Configure parameters according to the network environment. If the camera modified IP address is 192.168.110.205, then the way to get RTSP video streaming as below:

Default RTSP main streaming address:

rtsp://192.168.110.205:554/live/av0 (av0 Main)

Default RTSP sub streaming address:

rtsp://192.168.110.205:554/live/av1 (av1 Sub)

7.5.3 RTMP video streaming

Select "Setup" - "Network Settings" - "RTMP" to enter following interface:



Enable and turn on the RTMP video stream to the server

Server URL: server address, which can be domain name or IP address

Streaming code: Persistent Stream Key/Name

7.6 Software upgrade (upgrade if there is a new version)

7.6.1 Select "Setup"--"Maintenance"--"System Upgrade" to enter the following interface:



7.6.1.1 Open upgrade file to Upgrade automatically if needed.

7.6.1.2 Restart the camera and prompts "Upgrade succeeded". Log in to the network and check whether the software version is consistent with the upgrade file to ensure that the upgrading is successful. Then click "Restore factory default" to restart and restore the parameters to the factory default setting. (IP default 192.168.1.205, User default: admin, Password default: admin)

7.7 VISCA over IP

VISCA protocol is transmitted over IP to reduce the trouble of RS232/RS485 wiring(controller must support IP communication function)

Communication port specifications:

Control port: RJ45

IP protocol: IPv4

Transport protocol: UDP

IP address: set through the web

Port address: 52381

Scope of application: the same network segment

8. Installation Instructions

8.1 Surface Installation

Put the camera on the desk flatly, and make sure the camera is in a horizontal position. If you want to put the camera on an oblique surface, please make sure the angle of inclination is less than 15 degrees to ensure the camera pan and tilt work in normal operation.



8.2 Wall Mount Installation

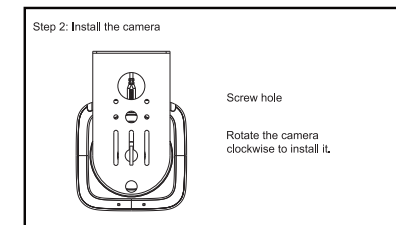
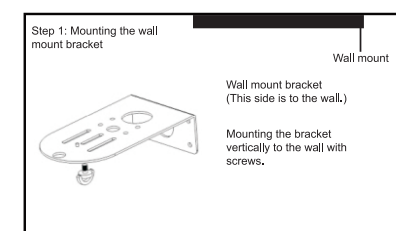

9. Trouble Shooting

Before requesting service to service engineer, please refer to the following methods to remove failures. If the failures still can't be solved, please contact us for assistance.

Q: The video of the camera cannot be displayed on the screen.
A: Please check the connection between power cable, video cable, camera and monitor, fix the connector on each end.

Q: It's unable to Pan, Tilt and Zoom camera.

A: Because the menu was displayed on monitor. Please re-operate after exiting the menu.

Q: Why the camera rotates for about 10 seconds after power on?

A: This is the normal self-test of the camera.

Q: Poor Image quality while using in church or other low-light conditions.

A: Press menu (ON/OFF) to adjust backlight effect to suit the church lighting properly.

Q: Remote control is not working or insensitive.

A: ①Not work, please replace batteries.

②Not sensitive: Choose the correct "IR select" number to correspond to the camera. Control the camera within 10m (32.8ft). Remove the obstacles. Aim at the sensor which is in front of the camera when controlling it.

Q: USB interface is not identifiable.

A: Please check if the USB cable and extension cable are well connected or not. If yes, change to another USB interface and try to connect again.

Q: It won't be controlled via RS-232/RS-485 when camera connect to PC.

A: Make sure it is a correct connection between the camera and PC. (Reference to RS-485 and RS-232 Pins distribution on page 10).

Q: Why no ceiling mount bracket?

A: Camera comes with wall mount. Ceiling mount or tripod brackets need to buy separately.

Q: Does this camera have built-in mic?

A: No, this camera comes with no built-in mic.

Q: Can we control the camera only by the remote control?

A: You can control the camera by remote control, keyboard controller (joystick), and software.

10. Maintenance Services

All products purchased from our company are guaranteed to keep in good repair for 36 months. If there are any quality problems during the guarantee period, we will maintain them for free.

Under any of the following warranties, related maintenance costs will be collected:

1. Product was not normally used.
2. Fire, electric shock, outside object collapse or other natural disasters causing the equipment damaged.
3. Unauthorized repair, misuse, abuse or change.